

**TETRA OPTICAL
MACRO SLAVE REPEATER**

- **4W MAX ALC RF OUTPUT POWER**
- **HIGH SENSITIVITY**
- **HIGH DYNAMIC RANGE**
- **SMALL SIZE**
- **OPTICAL MULTIWAVELENGTH TECHNIQUE**
- **FOR VARIOUS TOPOLOGY**

This repeater is intended to use for TETRA in or outdoor optical fibre systems. It is a compact and reliable unit, and it is especially advantageous to use it in areas where off air transmission is not preferable (like tunnels, large buildings etc.). The base station side optical master unit can communicate through optical fiber with slave unit on repeater side, which provides high flexibility in system build-up. This very economical solution can be installed easily, and the repeater can be set and monitored using the bundled remote control software.

Thanks to the multi wavelength technique up to 4 slaves can be connected to one master channel via 1 to 4 way optical in star topology. Using external optical couplers daisy chain topology can be realized.

Electrical characteristics:

Frequency Band Uplink	380 – 385 MHz *
Frequency Band Downlink	390 – 395 MHz *
Nominal Gain	65 dB
Gain Setting	40 to 65 dB adjustable in 1dB step
ICP3 Downlink	> 68 dBm typ.
Linear Output Power	+36 dBm ** @ -36dBm IM
Max. ALC Level	+36 dBm **
Uplink Path Noise Figure	< 5 dB @ max. gain
Pass Band Ripple	< ±1.5 dB max.
Gain Stability	< ±1.5 dB (within operating temp. range)
Optical Module Maximum RF Input Power	+5 dBm
Optical Connectors	LC/PC
RF Connectors	N-female
Power Supply	100 - 240 VAC / 50 -60 Hz, optional DC 48 V
Power Consumption	< 100 W
Weight	25 kg
Size	420 x 400 x 175 mm
Operating Temperature Range	0°C to +45°C (optional -25°C to +55°C ***)
Storage Temperature Range	-30°C to +70°C
Local Control	RS232
Remote Control	Through optical fibre with master unit
Degree of Protection	Outdoor

(*) Other standard TETRA bands are also possible.

(**) According to the customer request other downlink RF power level version also possible.

(***) with extra heatsink (40mm → 80mm)

Specifications are subject to change without notice.

TETRA OPTICAL MACRO SLAVE REPEATER

Outline dimensions (mm):

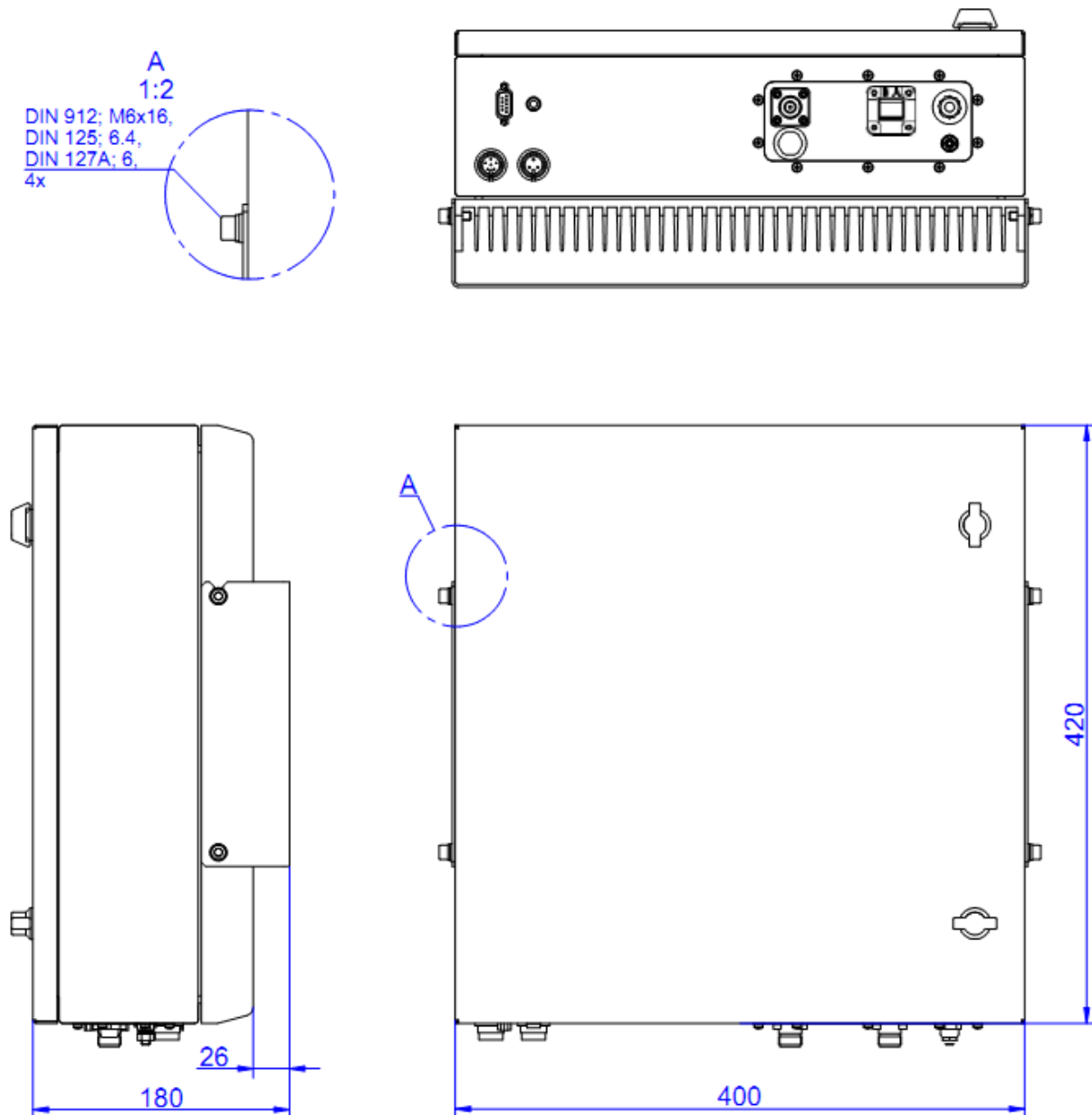

Optional in 19" rack